

GENERAL MACHINING TOLERANCE - GRADO MEDIUM (UNI EN ISO 22768)												
TOLLERANZA GENERALE DI LAVORAZIONE - GRADO MEDIO (UNI EN ISO 22768)												
Size	above	Gruppo di dimensioni		oltre	-	5	120	400	1000	2000	4000	
	up to	fino a		fino a	6	30	120	400	1000	2000	4000	
Tolerance	Sostamenti				±0.1	±0.2	±0.3	±0.5	±0.8	±1.2	±2	±3

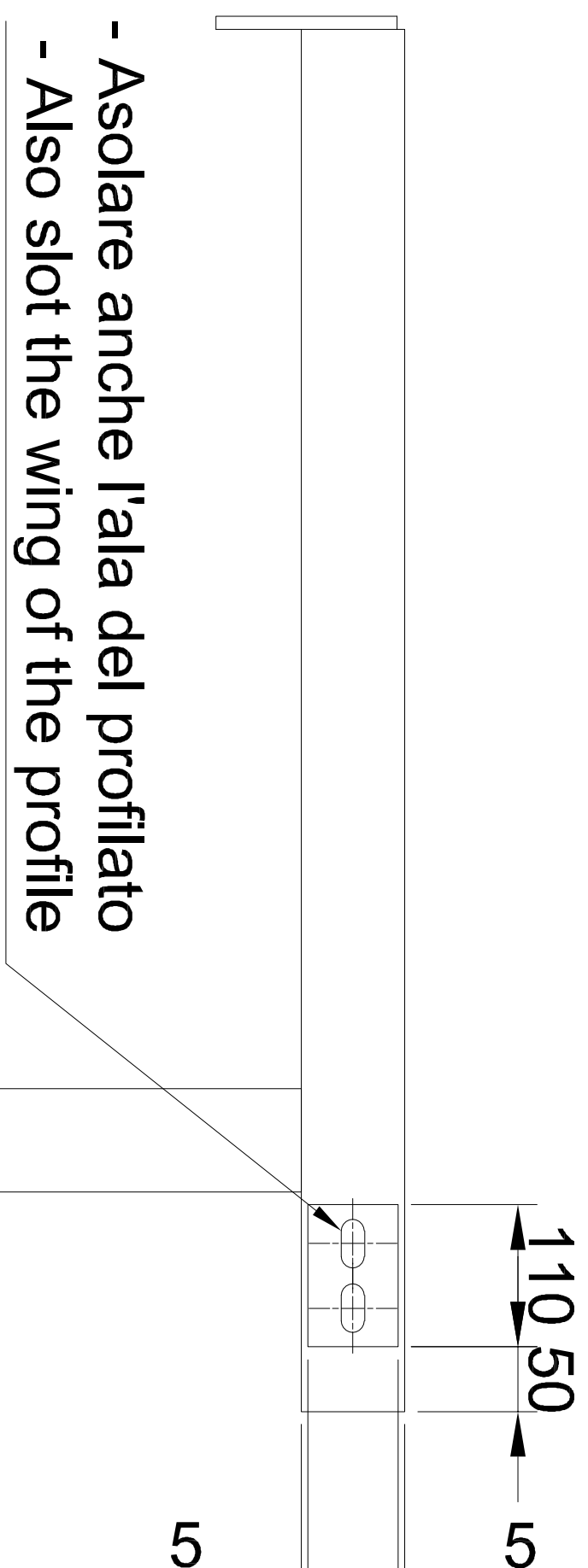
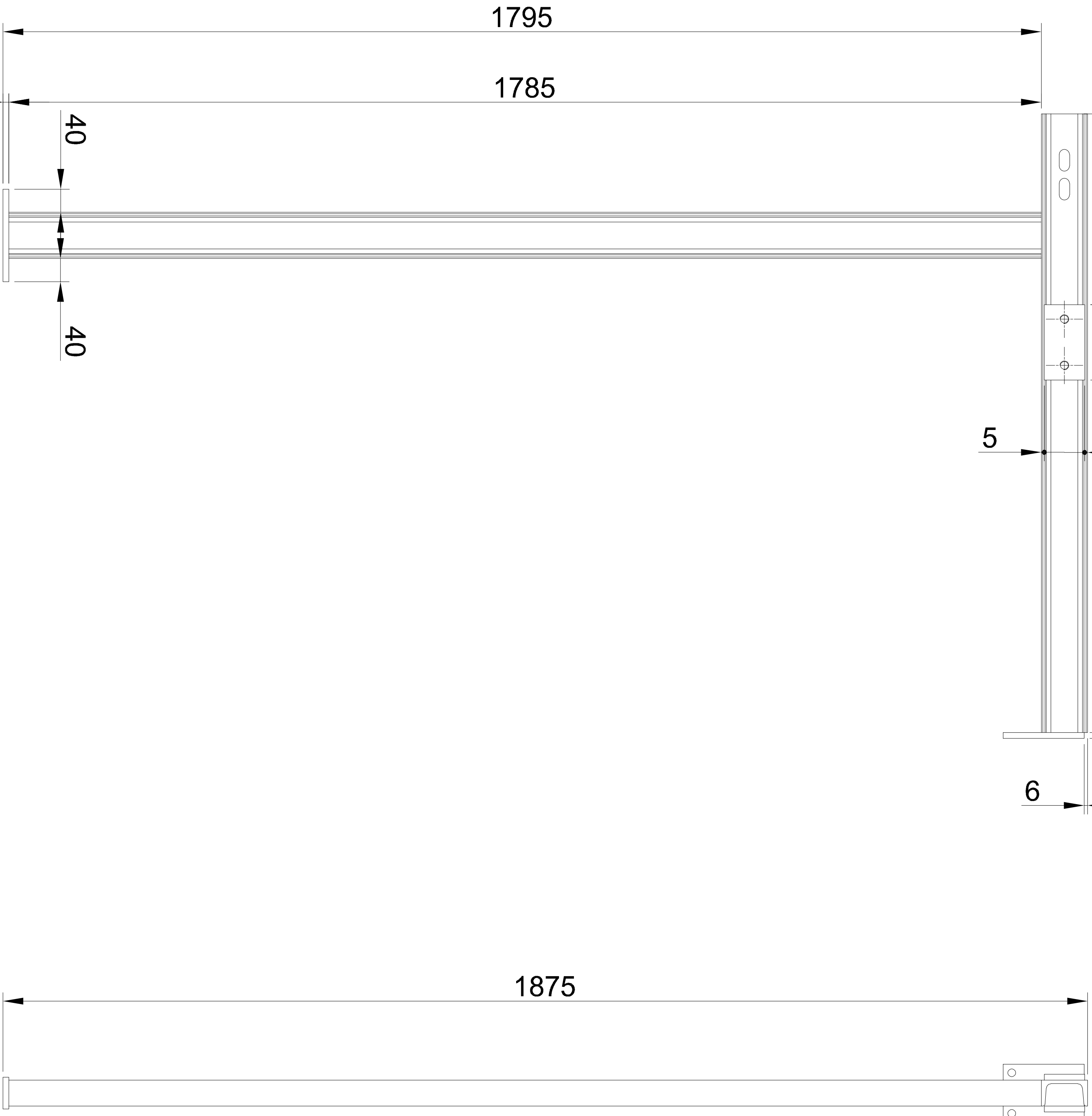
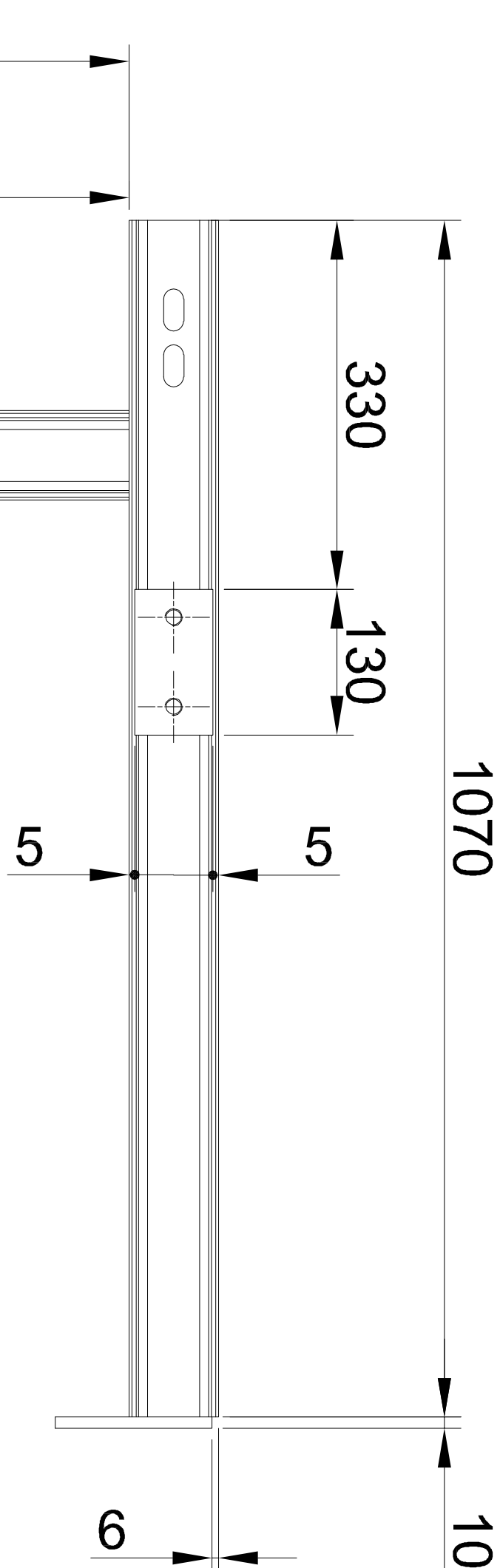

PAINTING STANDARDS

Paint the unworked surfaces as indicated:
 - n°1 layer of inorganic Zinc, thickness 75µm,
 - n°1 or more layers of two-component epoxy paint, thickness 175µm
 The thickness of the final layer will therefore be no less than 250µm.

RAL

NORME GENERALI DI SALDATURA

GENERAL RULES FOR WELDED JOINTS

PREPARAZIONE DEI LEMBI SECONDO "DIN
EDGE PREPARATION FOR WELDING ACCORDING TO
DOVE NON AL TRIMMENTI INDICATO - A = 0,7.7.7
DELLO SPESSORE MINIMO DA COLLEGARE
WHERE NOT SPECIFIED - A = 0.7
OF THE MINIMUM THICKNESS TO BE JOINT

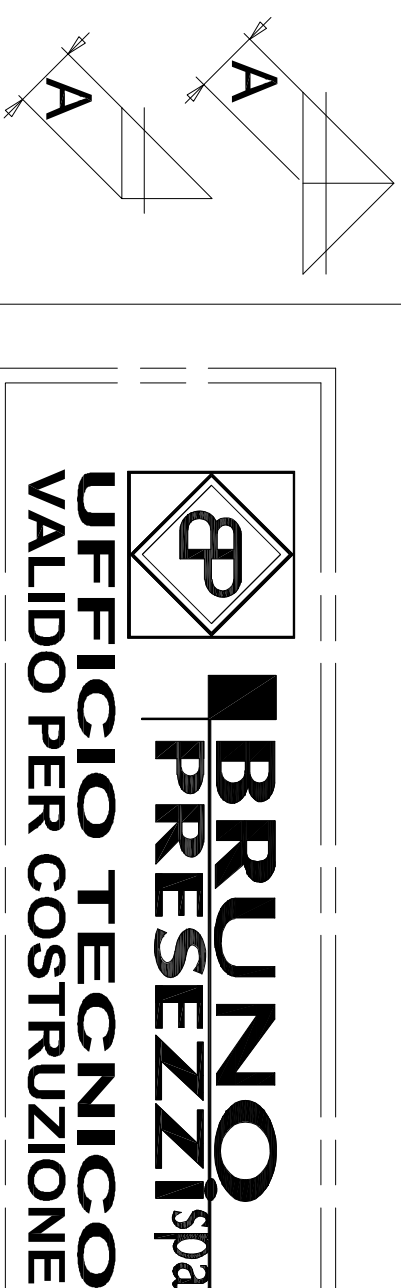

Q.tà	Descrizione	Description	Pos.	Materiale	Numero Parte	Massa	R.T.C.
1	Plastra	Plate	106	S275JR EN 10025		0,7	
1	Plastra	Plate	105	S275JR EN 10025		0,7	
1	Plastra	Plate	104	S275JR EN 10025		0,6	
1	Plastra	Plate	103	S275JR EN 10025		1,1	
1	Profilato UPN 80 - L=1785 - UNI EN 10279	UPN 80 Profile - L=1785	102	S275JR EN 10025		15,4	
1	Profilato UPN 80 - L=1070 - UNI EN 10279	UPN 80 Profile - L=1070	101	S275JR EN 10025		9,3	

Descrizione:

Trave sostegno lamiera

(Sheet metal support beam,

DIS. ASSIEME		COMMESSA	
			
<p>A terminie di legge e' rigorosamente vietato riprodurre o comunicare a terzi il contenuto del presente disegno</p>		<p>Disegno N.</p>	
<p>60-26-00B-105</p>		<p>Scala: 1 : 10</p>	
<p>Revisione: 0</p>		<p>Revisione: 0</p>	
<p>Foglio: 1 di 1</p>		<p>Foglio: 1 di 1</p>	
<p>Via per Orongo 8 - BUSAIO DI MOLIGORA - C.A.P. 28075 (NB) - ITALY Tel. 039/635021 FAX 039/6801373 - e-mail: buino.presazzi@buinopresazzi.com</p>		<p>A2</p>	

GENERAL MACHINING TOLERANCE - GRADO MEDIUM (UNI EN ISO 22768)												
TOLLERANZA GENERALE DI LAVORAZIONE - GRADO MEDIO (UNI EN ISO 22768)												
Size	above	Gruppo di dimensioni		oltre	-	5	120	400	1000	2000	4000	
	up to	fino a		fino a	6	30	120	400	1000	2000	4000	
Tolerance	Sostamenti				±0.1	±0.2	±0.3	±0.5	±0.8	±1.2	±2	±3

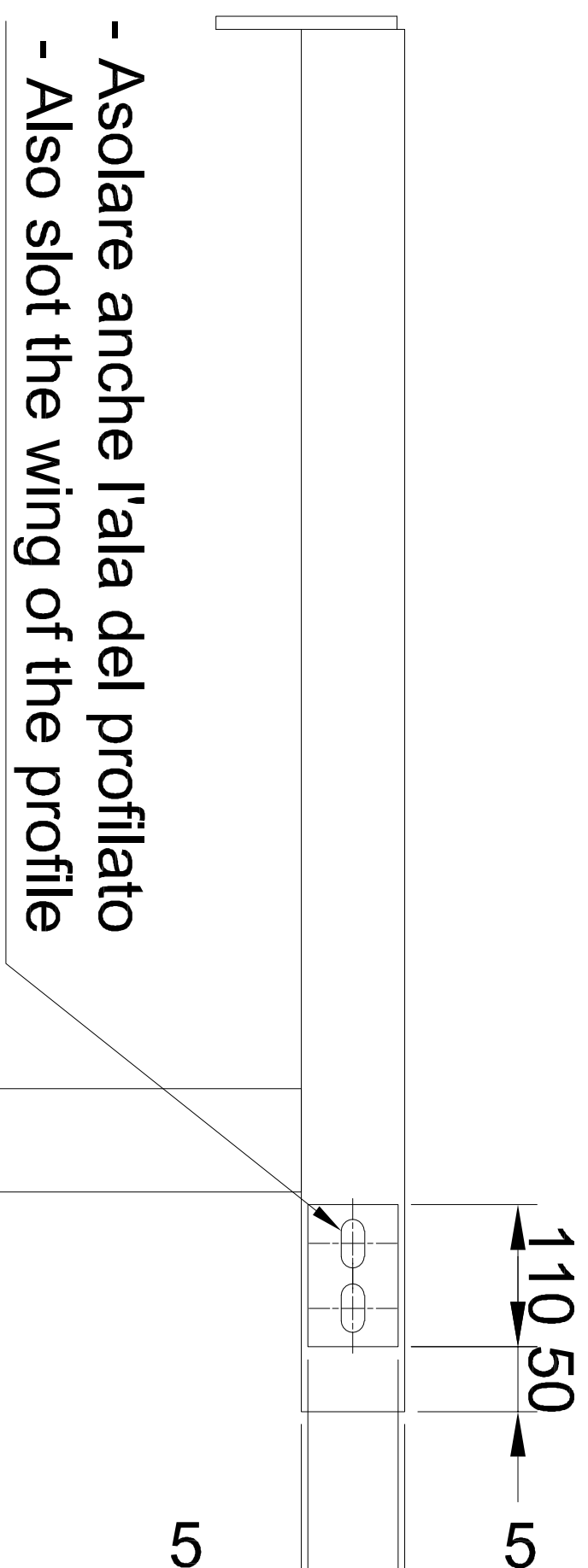
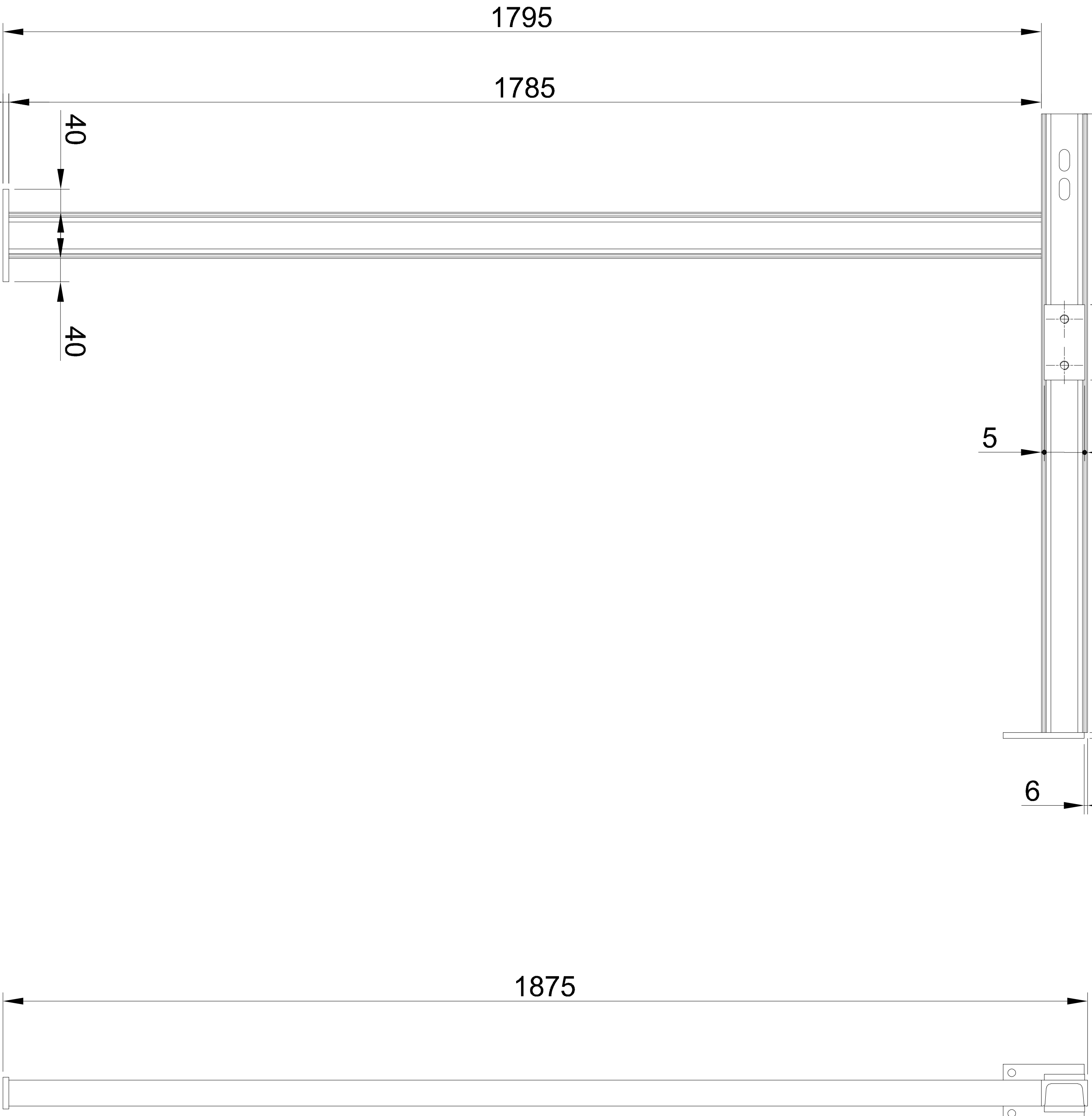
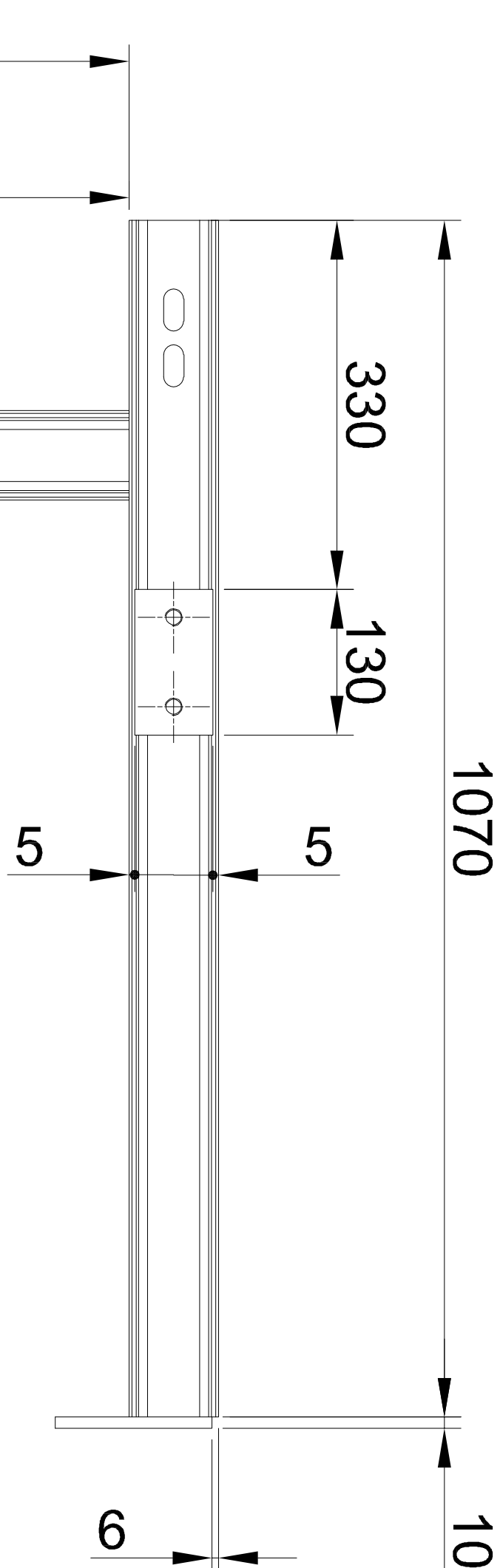

PAINTING STANDARDS

Paint the unworked surfaces as indicated:
 - n°1 layer of inorganic Zinc, thickness 75µm,
 - n°1 or more layers of two-component epoxy paint, thickness 175µm
 The thickness of the final layer will therefore be no less than 250µm.

RAL

NORME GENERALI DI SALDATURA

GENERAL RULES FOR WELDED JOINTS

PREPARAZIONE DEI LEMBI SECONDO "DIN
EDGE PREPARATION FOR WELDING ACCORDING TO
DOVE NON AL TRIMMENTI INDICATO - A = 0,7.7.7
DELLO SPESSORE MINIMO DA COLLEGARE
WHERE NOT SPECIFIED - A = 0.7
OF THE MINIMUM THICKNESS TO BE JOINT

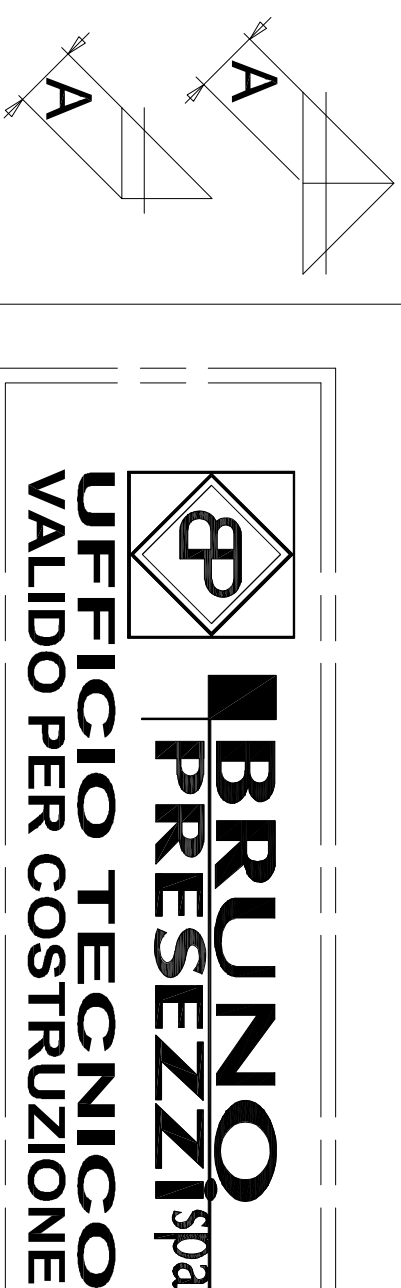

Q.tà	Descrizione	Description	Pos.	Materiale	Numero Parte	Massa	R.T.C.
1	Plastra	Plate	106	S275JR EN 10025		0,7	
1	Plastra	Plate	105	S275JR EN 10025		0,7	
1	Plastra	Plate	104	S275JR EN 10025		0,6	
1	Plastra	Plate	103	S275JR EN 10025		1,1	
1	Profilato UPN 80 - L=1785 - UNI EN 10279	UPN 80 Profile - L=1785	102	S275JR EN 10025		15,4	
1	Profilato UPN 80 - L=1070 - UNI EN 10279	UPN 80 Profile - L=1070	101	S275JR EN 10025		9,3	

Descrizione:

Trave sostegno lamiera

(Sheet metal support beam,

DIS. ASSIEME		COMMESSA	
			
<p>A terminie di legge e e' rigorosamente vietato riprodurre o comunicare a terzi il contenuto del presente disegno</p>		<p>Disegno N.</p>	
<p>60-26-00B-105</p>		<p>Scala: 1 : 10</p>	
<p>Revisione: 0</p>		<p>Revisione: 0</p>	
<p>Foglio: 1 di 1</p>		<p>Foglio: 1 di 1</p>	
<p>Via per Orongo 8 - BUSAIO DI MOLLORFA - C.A.P. 28075 (MB) - ITALY Tel. 039/635021 FAX 039/6801373 - e-mail: buino.presazzi@buinopresazzi.com</p>		<p>A2</p>	

GENERAL MACHINING TOLERANCE - GRADO MEDIUM (UNI EN ISO 22768)												
TOLLERANZA GENERALE DI LAVORAZIONE - GRADO MEDIO (UNI EN ISO 22768)												
Size	above	Gruppo di dimensioni		oltre	-	5	120	400	1000	2000	4000	
	up to	fino a		fino a	6	30	120	400	1000	2000	4000	
Tolerance	Sostantamenti				±0.1	±0.2	±0.3	±0.5	±0.8	±1.2	±2	±3

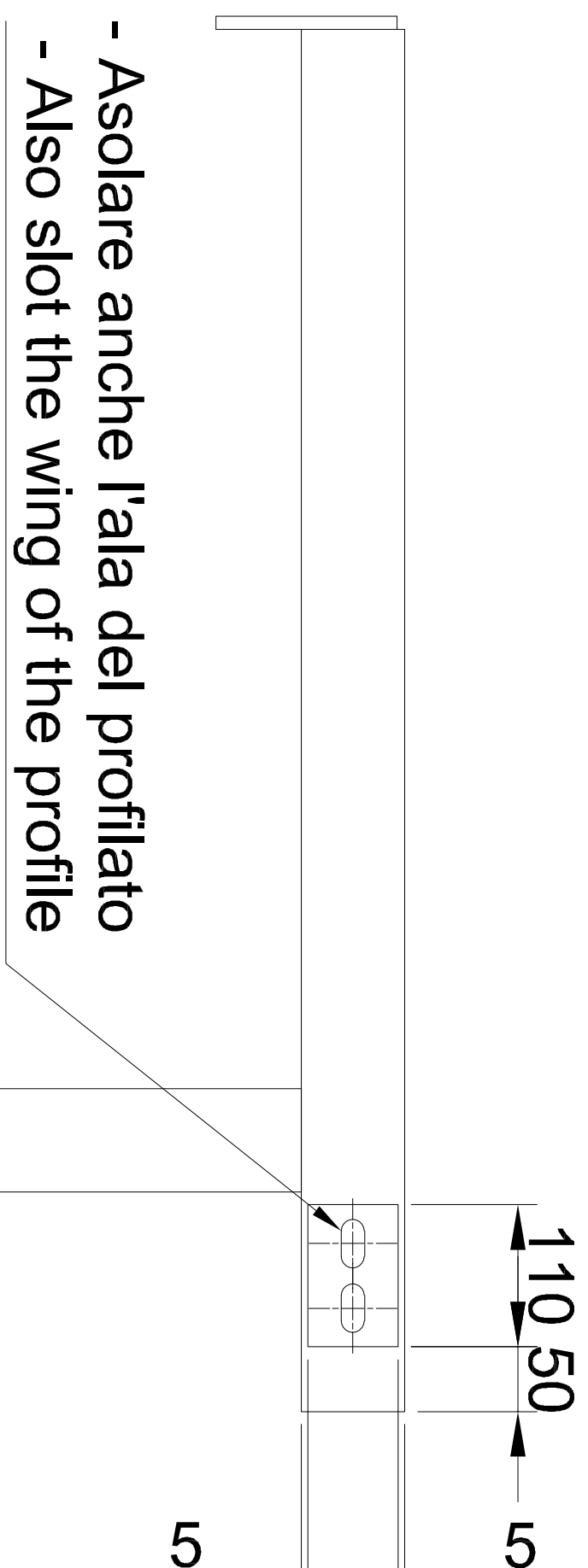
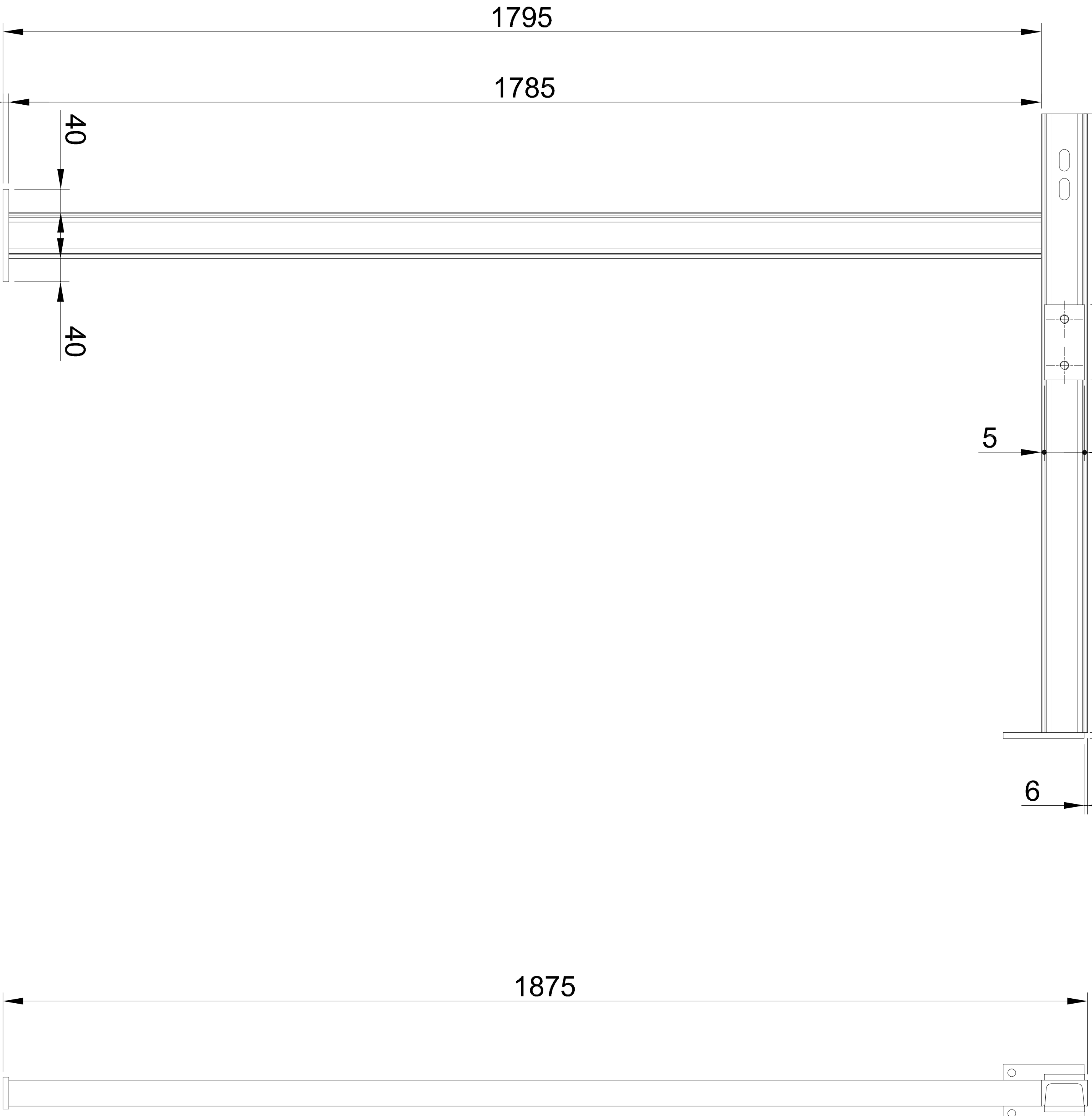
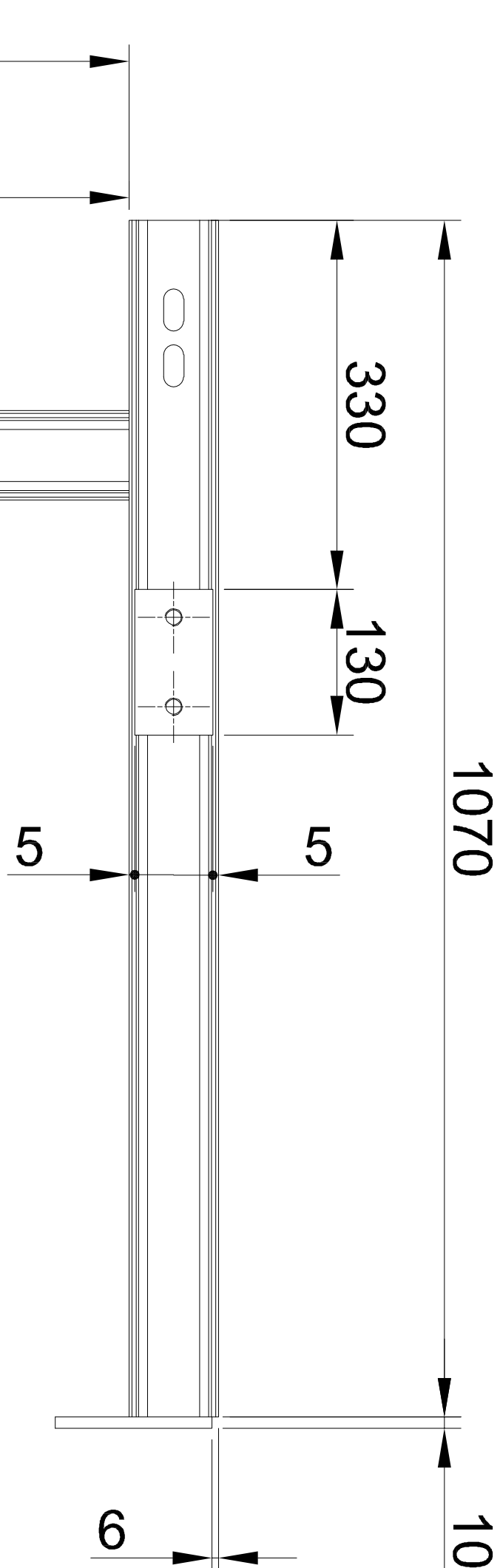

PAINTING STANDARDS

Paint the unworked surfaces as indicated:
 - n°1 layer of inorganic Zinc, thickness 75µm,
 - n°1 or more layers of two-component epoxy paint, thickness 175µm
 The thickness of the final layer will therefore be no less than 250µm.

RAL

NORME GENERALI DI SALDATURA

GENERAL RULES FOR WELDED JOINTS

PREPARAZIONE DEI LEMBI SECONDO "DIN EN 10157-2"
EDGE PREPARATION FOR WELDING ACCORDING TO
DIN EN 10157-2
DOVE NON ALTRIMENTI INDICATO - A = 0,7.7
DELLO SPESSORE MINIMO DA COLLEGARE
WHERE NOT SPECIFIED - A = 0,7
OF THE MINIMUM THICKNESS TO BE JOINT

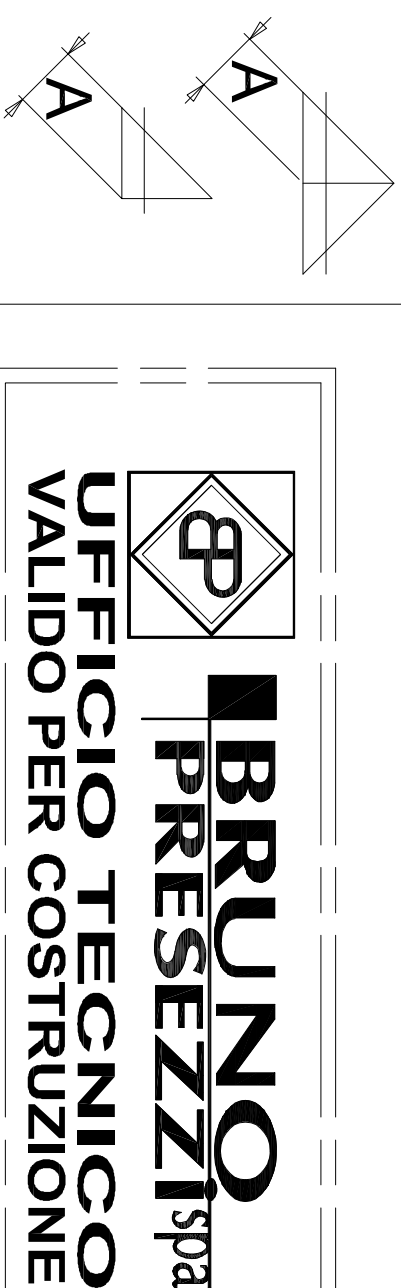



1	Plastra	Plate	106	S275JR EN 10025		0,7	
1	Plastra	Plate	105	S275JR EN 10025		0,7	
1	Plastra	Plate	104	S275JR EN 10025		0,6	
1	Plastra	Plate	103	S275JR EN 10025		1,1	
1	Profilato UPN 80 - L=1785 - UNI EN 10279	UPN 80 Profile - L=1785	102	S275JR EN 10025		15,4	
1	Profilato UPN 80 - L=1070 - UNI EN 10279	UPN 80 Profile - L=1070	101	S275JR EN 10025		9,3	
Q.tà	Descrizione	Description	Pos.	Materiale	Numero Parte	Massa	R.I.C.

Descrizione:

Trave sostegno lamiera

(Sheet metal support beam,

DIS. ASSIEME		COMMESSA	
			
<p>A terminie di legge e' rigorosamente vietato riprodurre o comunicare a terzi il contenuto del presente disegno</p>		<p>Disegno N.</p>	
<p>60-26-00B-105</p>		<p>Scala: 1 : 10</p>	
<p>Revisione: 0</p>		<p>Revisione: 0</p>	
<p>Foglio: 1 di 1</p>		<p>Foglio: 1 di 1</p>	
<p>Via per Orongo 8 - BUSAJO DI MOLGORA - C.A.P. 28075 (MB) - ITALY Tel. 039.6152021 FAX 039.615011373 - e-mail: buino.pressezi@buinopressezi.com</p>			
A2		A2	